

FURUTECH

PURE TRANSMISSION

AEx

オーディオ銘機賞

Audio Excellence Award 2008



High Performance Schuko Wall Socket FP-SWS(G) 16A 250V



Type: 2-pole+earth

Rating: 16A 250V A.C.

Features:

- α (Alpha) Pure copper Conductor (t : 0.5mm)
- Material: Nylon/fiberglass body and Poly carbonate cover; 1.0mm thick zinc/steel brace plate bracket with ABS Front Plate and FO-Q vibration damping material.
- Specified for wire diameters of 2.5mm (set screw)
- Dimensions: 95.0mm (L) x 95.0mm (W) x 45.9mm(H)
- Furutech's total attention to detail and build quality extends right down to a specially designed patent-pending pressure plate (see below) that increases the contact area of the Alpha Conductors.

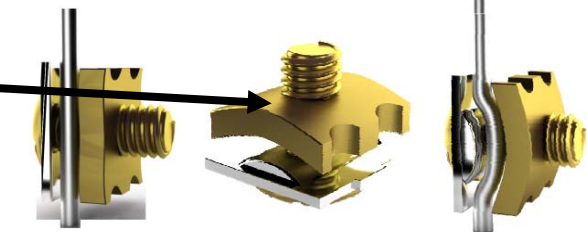
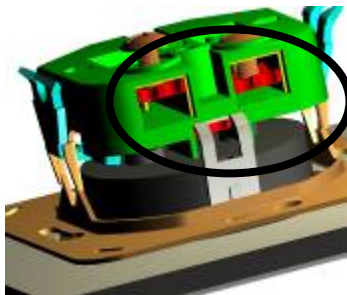

Regular Clamp

Furutech Patent Pending Clamp

Contact Area Calculated Increase: 17.142%

All metallic parts are treated with the

**FURUTECH α (Alpha) Process (Super Cryogenic & Demagnetizing Treatment.)*

FURUTECH CO.,LTD service@furutech.com

Make A More Powerful Connection with Furutech!